



LADDERS & PLATFORMS

LADDERS & PLATFORMS

Aluminium Platform

Easy Access Platform Ladder

Trade Platform Ladder. Riveted Rungs, 180kg weight limit and has a 2 year warranty.



Code	Platform Height	Steps
OXPL02	0.6M	2 step
OXPL03	0.9M	3 step
OXPL04	1.2M	4 step
OXPL06	1.8M	6 step
OXPL08	2.4M	8 step

Easy Access Adjustable Platform Ladder

Trade Adjustable Platform Ladder. Riveted Rungs, 200kg weight limit.



Code	Platform Height	Steps
OXTPL03-05	0.84-1.44M	3-5 step
OXTPL04-07	1.15-2.02M	4-7 step
OXTPL05-09	1.44-2.60M	5-9 step

Bailey Adjustable Platform Ladder

Quickly converts from a 3 step platform stepladder to a 4, 5, or 6 step platform stepladder using a single handed operation. 170kg weight limit.



Code	Platform Height	Steps
FS13999	0.85-1.71M	3-6 step

Bailey P150 Platform Ladder

Designed to provide users with an exceptionally lightweight yet highly functional platform stepladder. 150kg weight limit.



Code	Platform Height	Steps
FS13580	0.9M	3 step
FS13581	1.2M	4 step
FS13582	1.5M	5 step
FS13583	1.8M	6 step

Bailey Job Station Platform Ladder

Professional Platform Ladder with wheels. 170kg weight limit. 2 year warranty.



Code	Platform Height	Steps
FS13538	0.9M	3 step
FS13539	1.2M	4 step
FS13540	1.5M	5 step
FS13541	1.8M	6 step
FS13542	2.03M	7 step
FS13543	2.32M	8 step
FS13544	2.91M	10 step
FS13545	3.60M	12 step

Warthog Platform Ladder

Industrial Platform Ladder. Welded Rungs, 200kg weight limit. Castors & full surround handrail available. 10 year warranty.



Code	Height	Steps
WHPL02	0.6M	2 step
WHPL03	0.9M	3 step
WHPL04	1.2M	4 step
WHPL05	1.5M	5 step
WHPL06	1.8M	6 step
WHPL07	2.1M	7 step
WHPL08	2.4M	8 step
WHPL09	2.7M	9 step
WHPL10	3.0M	10 step

Aluminium Dual Purpose

Easy Access Dual Purpose Ladders

Trade Dual Purpose Ladder. Braced side arms to improve stability and doubling as a handy tool tray. 150kg weight limit.



Code	Height	Steps
OXSE06	1.8M	6 step
OXSE07	2.1M	7 step
OXSE08	2.4M	8 step

Bailey Pro Dual Purpose Ladders

Professional Dual Purpose Ladder. Punchlock rungs, 150kg weight limit and 2 year warranty.



Code	Height	Steps
FS13988	1.8M	6 step
FS13989	2.1M	7 step
FS13990	2.4M	8 step

Warthog Dual Purpose Ladders

Industrial Dual Purpose Ladder. Welded rungs, 180kg weight limit and 10 year warranty.



Code	Height	Steps
WHSE04	1.2M	4 step
WHSE05	1.5M	5 step
WHSE06	1.8M	6 step
WHSE07	2.1M	7 step
WHSE08	2.4M	8 step
WHSE09	2.7M	9 step
WHSE10	3.0M	10 step

Telescopic Ladders

Easy Access Telescopic Ladder

Trade All-in-One Telescopic Ladder. 150kg Weight Limit.



Code	Height
OXTL03	0.9 - 3.3M
OXTL04	1.2 - 4.5M
OXTL05	1.5 - 5.7M

Bailey Telescopic Ladder

The Bailey FS13644 converts into four different configurations, a double sided stepladder, a single straight ladder, two individual trestles and a telescopic adjustable ladder. 135kg load rating.



Code	Height
FS13644	2.3 - 4.5M

Single Ladders

CSL Single Ladders

Trade Single Ladder.
D shaped step.
150kg weight limit



Code	Height	Steps
CSL3.0	3.0M	7 step
CSL3.6	3.6M	9 foot
CSL4.8	4.8M	13 step
CSL5.4	5.4M	17 step

Double Sided Ladders

Easy Access Double Sided Ladder

Trade Double Sided Ladder. Heavy duty ladder feet, a huge 180kg weight limit.

Code	Height	Steps
OXDS02	0.6M	2 step
OXDS03	0.9M	3 step
OXDS04	1.2M	4 step



Bailey Pro Double Sided Ladder

Professional Double Sided Ladder. Punchlock Rungs, 150kg weight limit and 2 year warranty.

Code	Height	Steps
FS13960	0.9M	3 step
FS13961	1.2M	4 step
FS13963	1.8M	6 step
FS13965	2.4M	8 step



Warthog Double Sided Ladder

Industrial Double Sided Ladder. Welded Rungs, 180kg weight limit and 10 year warranty.

Code	Height	Steps
WHDS02	0.6M	2 step
WHDS03	0.9M	3 step
WHDS04	1.2M	4 step
WHDS05	1.5M	5 step
WHDS06	1.8M	6 step
WHDS07	2.1M	7 step
WHDS08	2.4M	8 step
WHDS09	2.7M	9 step



Aluminium Extension Ladders

LADDERS & PLATFORMS

Bailey Pro Extension

Professional Extension Ladder. Punchlock Rungs, 150kg weight limit and 2 year warranty.



Code	Height	Steps
FS13897	2.5-4.0m	8+
FS13898	3.1-5.3m	10+
FS13899	3.7-6.5m	12+
FS13900	4.4-7.7m	14+
FS13901	5.0-9.0m	16+
FS13902	5.6-10.0m	18+
FS13903	6.2-11.0m	20+



Bailey Pro Extension with Leveller Feet

Professional Extension Ladder. Punchlock Rungs, 150kg weight limit and 2 year warranty.



Code	Height	Steps
FS13905	3.18-5.01m	10 Step
FS13906	3.79-6.23m	12 Step



Order Pickers

Warthog Standard Order Pickers

Standard Order Picker with wheels & handrail. ladder folds flat to assist with storage and handling. Sturdy; fully welded joints, no rivets to work loose over time. 180kg weight limit.

Code	Platform Height	Steps
WHOP05/WC	1.5M	5 step
WHOP06/WC	1.8M	6 step
WHOP07/WC	2.1M	7 step
WHOP08/WC	2.4M	8 step
WHOP09/WC	2.7M	9 step
WHOP10/WC	3.0M	10 step
WHOP11/WC	3.3M	11 step
WHOP12/WC	3.6M	12 step



Warthog Heavy Duty Order Picker

Heavy Duty Order Picker with wheels & handrail. Welded rungs and a 10 year warranty. Large work surface and 225kg SWL for all maintenance requirements. 200mm solid rubber wheels allow for easy relocation on all terrains.

Code	Platform Height	Steps
WHDP02	565mm	2 Step
WHDP03	850mm	3 Step
WHDP04	1130mm	4 Step
WHDP05	1400mm	5 Step
WHDP06	1700mm	6 Step
WHDP07	1970mm	7 Step
WHDP08	2250mm	8 Step
WHDP09	2540mm	9 Step
WHDP10	2828mm	10 Step
WHDP11	3100mm	11 Step



Warthog Heavy Duty Cantilever Order Picker

Heavy Duty Cantilever Order Picker with wheels & handrail. Welded rungs and a 10 year warranty. Allows you to get right into and up against your work area without reaching out from the platform. Built tough, non-slip perforated deck and aluminium frame. 225kg weight limit.

Code	Platform Height	Steps
WHDPC02	565mm	2 Step
WHDPC03	850mm	3 Step
WHDPC04	1130mm	4 Step
WHDPC05	1400mm	5 Step
WHDPC06	1700mm	6 Step
WHDPC07	1970mm	7 Step
WHDPC08	2250mm	8 Step
WHDPC09	2540mm	9 Step
WHDPC10	2828mm	10 Step
WHDPC11	3100mm	11 Step



Fibreglass Platform Ladders

LADDERS & PLATFORMS

Bailey Fibreglass Job Station

Professional Fibreglass Job Station Platform Ladder suited for electrical work. Punchlock rungs, 170kg weight limit.



Branach Fibreglass

Industrial Fibreglass Platform Ladder with full surround handrail and adjustable terrain master feet. Suited for electrical & transmission work, 150kg weight limit.



Code	Height	Steps
FS13530	0.9M	3 step
FS13531	1.2M	4 step
FS13532	1.5M	5 step
FS13533	1.8M	6 step
FS13534	2.0M	7 step
FS13535	2.4M	8 step
FS13536	3.0M	10 step
FS13537	3.6M	12 step

Code	Height	Steps
FPW0.6	0.6M	2 step
FPW0.9	0.9M	3 step
FPW1.2	1.2M	4 step
FPW1.5	1.5M	5 step
FPW1.8	1.8M	6 step
FPW2.1	2.1M	7 step
FPW2.4	2.4M	8 step
FPW3.0	3.0M	10 step
FPW3.6	3.6M	12 step



Fibreglass Telescopic Platform Ladder

Easy Access AdjustaStep

Designed with the Electrical Trades in mind, this AdjustaStep Telescopic Platform ladder is non-conductive, and has a 150g load rating.

Height adjustable for working off a large safe platform at variable heights in seconds. Set front and back stiles to varying heights for working on steps or uneven ground. Handrail allows for 3 points of contact.

Can be fitted with accessories including tool bucket and full surround handrail.

Code
OXTPLF04-07

Platform Height
1.15 - 2.02M

Steps
4 - 7 step



Fibreglass Double Sided



Easy Access Fibreglass Double Sided

Trade Fibreglass Double Sided Ladder suited for electrical work. Riveted rungs, 150kg weight limit.

Code	Height	Steps
OXDSF03	0.9M	3 step
OXDSF04	1.2M	4 step
OXDSF06	1.8M	6 step
OXDSF08	2.4M	8 step



Bailey Pro Fibreglass Double Sided

Industrial Fibreglass Double Sided Ladder suited for electrical work. Punchlock rungs, 150kg weight limit.



Code	Height	Steps
FS13977	0.9M	3 step
FS13978	1.2M	4 step
FS13980	1.8M	6 step
FS13981	2.1M	7 step
FS13982	2.4M	8 step
FS13983	3.0M	10 step
FS13984	3.59M	12 step

Fibreglass Dual Purpose

Bailey Pro Fibreglass Dual Purpose Ladder

Industrial Fibreglass Dual Purpose Ladder suited for electrical work. Punchlock rungs, 150kg weight limit.



Code	Height	Steps
FS13668	1.8 - 3.2m	6 step
FS13669	2.1 - 3.8M	7 step
FS13670	2.4 - 4.4M	8 step

Fibreglass Step Extension

Bailey Pro Fibreglass Step Extension Ladder

Industrial Fibreglass Step Extension Ladder suited for electrical work. Punchlock rungs, 150kg weight limit.



Code	Height	Steps
FS13985	1.8 - 3.2M	6 step+
FS13986	2.1 - 3.8M	7 step+
FS13987	2.4 - 4.1M	8 step +

Fibreglass Extension Ladders

Easy Access Fibreglass Extension Ladder

Trade Fibreglass Extension Ladder suited for electrical work. Side mounted rope which avoids tripping hazard. Triple pulley - three times easier to lift. Heavy duty feet. 'D' Shape steps for comfortable standing. Up to 150kg weight limit.

Code	Height	Steps
OXELF09	3.15 - 5.30M	9 step
OXELF11	3.75 - 6.50M	11 step
OXELF13	4.20 - 6.90M	13 step



Bailey Pro Fibreglass Extension Ladder

Industrial Fibreglass Extension Ladder suited for electrical work. Strong fibreglass construction resists sway, turn and flex. Fitted with pole support 'Vee' Bracket. Flat 'D' shaped rungs for secure footing. Side pulley and rope extension system keep rope away from the user's feet. Up to 150kg weight limit.

Code	Height	Step
FS13917	2.6 - 4.1M	8 step
FS13918	3.2 - 5.3M	10 step
FS13919	3.8 - 6.6M	12 step
FS13920	4.4 - 7.8M	14 step
FS13921	5.0 - 9.0M	16 step



Branach Extension Ladders

Fibreglass Extension Ladder - 160kg Rated

Our Branach PowerMaster Extension Ladder range features Branach's unique strongbox construction. This allows for dramatic rigidity which greatly reduces twist and sway. They are designed for maximum safety when working at heights. Branach care about safety and convenience. That's why they invented the Branach latch which is situated at the top of the ladder. With single hand operation and side-pull rope (no trip hazard) the latch protects the rungs. The Branach D Rung provides stability and comfort when working at height, and its non-slip-surface ensures safety in all weather. A proven product you can trust. The Swivel Foot gives workers peace of mind when working on rough and slippery surfaces. Branach's unique fibreglass patented box rail construction provides superior safety and meets the needs of industry leaders.

- Fibreglass stiles ensure workers are isolated from the ground, making the product suitable for electrical work
- Lightweight and effortless action to deploy
- Flat D rungs provide safety and comfort to the worker
- Strongbox construction results in dramatic reduction in twist and sway
- Branach Latch or Conventional Latch available
- All-weather resistant
- Swivel foot maximises grip on uneven ground
- Optional TerrainMaster feet for working on uneven ground
- Complies to AS/NZS 1892.3 Standard

Code	Height
FED4.0	2.7 - 4.0M
FED5.2	3.3 - 5.2M
FED6.4	3.9 - 6.4M
FED7.6	4.5 - 7.6M
FED8.8	5.1 - 8.8M
FED9.4	5.8 - 9.4M
FED9.8	5.8 - 9.8M

TerrainMaster Feet

The TerrainMaster removes the need for dangerous chocking or digging out the ground to level out the ladder. As the user and terrain are never consistent the TerrainMaster creates the safest environment to work in every time it is used.

- Manufactured from lightweight aircraft aluminium
- Eliminates lateral twist and sideways movement.
- Easy to store, spread, and level
- Base can be set to a width of 925mm to 1440mm.
- Leg height can be adjusted to up to 305 mm.
- Allows coping with a slope of up to 15 degrees.



Fibreglass Fall Control System Ladders

A system to ensure the height worker is safe while ascending, descending or accidental fall, slip or medical issue. The elements of the Branach Fall Control address:

- STRENGTH** required to arrest the user.
- STABILITY** required to remain upright during a fall event.
- ANCHORING** mechanism to ensure the user does not separate from the ladder structure.
- RESCUE** so the height worker can be safely lowered down by someone on the ground.

- The worker is safe from the moment they leave the ground.
- The stability system works from the ground up.
- Fall control system stems from the increased base of support.
- The ladder is secured with an integrated tether system.
- Integrated rescue by second user from the ground.
- Allows workers to work from the ladder with both hands comfortably and safely.
- To meet and exceed compliance and international standards.
- Design fit for purpose, critical piece of climbing equipment.
- Periodic inspection schedule recommended.
- Complies to AS/NZS 1892.3 Standard

Code	Height
FED4.0FC	2.7 - 4.0M
FED5.2FC	3.3 - 5.2M
FED6.4C	3.9 - 6.4M
FED7.6FC	4.5 - 7.6M
FED8.8FC	5.1 - 8.8M



Roof Ladders

Trade Roof Ladder

Access to any roof with a pitch of up to 45 degrees.
Ridge bracket and wheels can be brought separately.

Code	Size
CSL3.0	3.0M
CSL3.6	3.6M
CSL4.8	4.8M
CSL5.4	5.4M
ULRB	Ridge Bracket



Professional Roof Ladder

Safe access to any roof with a pitch of up to 45 degrees.
Easy and efficient solution for roof painting and maintenance.

Code	Size
CSRL3.0	3.0M
CSRL3.6	3.6M
CSRL4.8	4.8M
CSRL5.4	5.4M
CSRL6.0	6.0M



Industrial Roof Ladder

Compliant with NZS Portable Metal Ladder Standards. 150kg Industrial Load Rated.
Extensions to fit any roof by using Internal joiner plates with Tri-knob fasteners.
RH100 swivel plate head with angle-lock & 25mm foam rubber pad.

Code	Size
RL1.8	1.8M
RL2.1	2.1M
RL2.4	2.4M
RL2.7	2.7M
RL3.0	3.0M
RL3.3	3.3M
RL3.6	3.6M
RL3.9	3.9M
RL4.2	4.2M
RL4.5	4.5M
RL4.8	4.8M
RL5.1	5.1M
RL5.7	5.7M
RL6.3	6.3M
JP20	Joiner Plates (pair)
RH100	Head



Roll up...



Over ridge...



Turn...



Connect...



Climb Safely.

Roof Walkers

Light weight and compact for transporting. Ideal for iron roofs. Difficult roof access made easy. 800mm wide.

Code	Description
RCLR	Roof Walkers



Self Levelling Stairs

Adjustable aluminium safety stair. Treads self level to suit the height. Safe, fast, easy access between floors, decks & in trenches. Folds flat for easy storage and relocation. Durable - built to last. Treads self level to suit any height. 300kg load rating.

Code	Steps
TF8	8 step safety stair
TF12	12 step safety stair
TF14	14 step safety stair



Truck Stairs

Developed specifically for access to truck trays. No fixings required. Treads self level to suit tray heights of 1 - 1.5m. Industrial use.

Code	Steps
TF6T	6 step truck stairs



Super Trestles

One piece, height adjustable, sets up in seconds. Large work area for industrial, trade use. Non-slip perforated platform deck guaranteed and proven safety. Folds down flat for easy transport & storage. Simply select the height by sliding in the pin. Optional handrail available.

Code	Deck Size	Platform Height
WST1000	450 x 1200	400 - 1000
WST1300	450 x 1600	600 - 1300
WST1700	450 x 1600	700 - 1700
WSTFSH10	Optional Handrail suitable for WST1000	
WSTFSH17	Optional Handrail suitable for WST1300-1700	



Podium

Code MPP600

Easy to use, walk in/walk out access. Two height settings 0.9m, 1.1m. Full surround handrails. Folds up flat in one piece for compact storage in seconds. Perfect for ceiling work and low level access. Large non-slip aluminium one man platform. Requires 2 x stabilizers.



Ladder Parts & Accessories

Standoff Ladder Bracket

Code TSS-STANDOFF

- Spring-loaded locking latch makes it easier and quicker to install/remove than any other stabilizer on the market
- Installation requires no tools
- Mar-resistant rubber end caps protect work surface
- Span: 1.1 m, Standoff: 25 cm
- Paint can hook included
- For use on Singles and Extensions with 3.2 cm round-rungs, 3.8 cm flat rungs, 4.4 cm flat rungs and 4.1 cm flat rungs.



Bailey Walk Through Ladder Arms

Code RBMH

Fits to wall at rood edge to enable roof to be safely accessed with no fear of your ladder sliding sideways.



Permanent Ladder Bracket

Code RBMH

Fits to wall at rood edge to enable roof to be safely accessed with no fear of your ladder sliding sideways.



Roof Bracket

Code ROOF

Hooks over ridge on steep roofs to support the top of the ladder. Can be easily installed on most single ladders.



Ladder Stopper

Code LJLADSTO

The Ladder Stopper is of a tough All-Rubber construction – One size fits all Ladders. Works in the wet and is suitable for most surfaces like grass, wood, stone, concrete, tiles, etc.

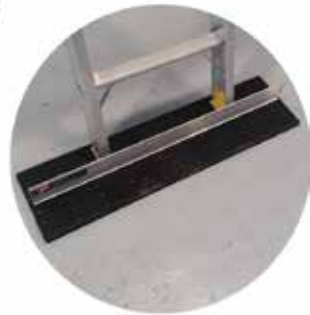

Steady On Bracket

Code MSTEADY

Designed to fit any size ladder and every type of spouting, you simply lift the bracket into place with a broom handle or roller pole, lean your ladder against it and up you go!



Ladder Parts

Bailey Ladder Parts

Code	Description
FS13954	Platform Safety Gate for Bailey P170
FS13584	Castor Kit for 3-6 step platform ladder - P150
FS13991	Platform wheels 2 - 5 step
FS13992	Platform wheels 7+ step
FS22703	Hooks - straight
FS22509	Side Arm Fem 3/4 Sat
FS22537	Side Arm Kit Gemini 8
FS22511	Side Arm Kit Gemini 6
FS22511	S/P Arm Replacement Kit FSE9-8
FS22508	Ladder Brace Arm Gemini
FS22508	S/P Arm Replacement Kit FSE6-8
FS22713	Internal Arm Kit DS 10
FS22719	Internal Arm Kit DS 6
FS22723	Internal Arm Kit DS 7/8
FS22991	S/Part Clutch Kit FSE
FS22859	S/Part Clutch Kit FSE
FS22765	S/Part Clutch Kit FSXN
FS22572	Feet Kit Ladderweld SS HD

Code	Description
FS22781	Ladder Feet SS AL 120/150
FS22967	Platform Ladder Feet
FS33116	Job Station Ladder Feet Kit
FS22564	Feet Kit Binks/D 28.33
FS22696	Single Ladder Feet
FS22574	Old Style o/p Feet
FS22731	Feet Single Ex Fg
FS22774	Feet SS/FSE/PLS Fg 150
FS22775	Feet DS/DP/FG
FS22778	S/P Feet Kit Galaxy L/Leveller
FS22779	Feet Kit Galaxy
FS22782	Feet DS/DP AL/STL 100-150
FS23071	Feet S/P Feet Op Mk 11
SP15-011AZ	Spare Part Feet Kit
SP15-008AZ	Spare Part Feet Kit
FS23125	S/P Button Comet Plus/Pcdp
FS22837	S/Part Pole Chain Kit FXN
FS22800	Rope Ext AL/FG/TIM 120-150



FS22731



FS23071



FS13954



FS22991 / FS22859



FS22774

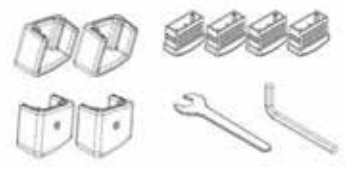

SP15-011AZ

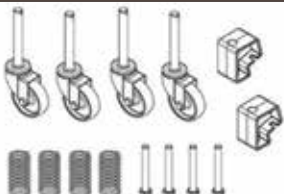

FS22991 / FS22992



FS22765

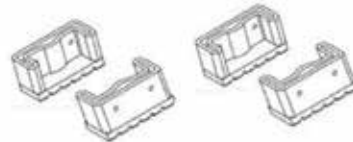

FS22775



SP15-008AZ



FS22703



FS22564



FS22778



FS23125



FS22509 / FS22537 / FS22511 / FS22508



FS22696



FS22779

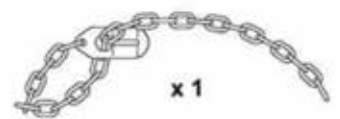

FS22837



FS22713 / FS22719 / FS22723



FS22574



FS22782

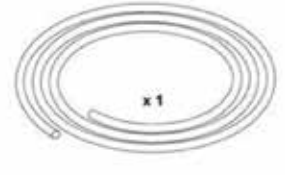

FS22800

Easy Access & Warthog Ladder Parts

Code	Description
WHADJFFET	Warthog Adjustable Feet (set of 4)
WHPLFSH	Warthog Platform Full Surround Handrail
OXPLFT	Easy Access Platform Ladder Feet (pair)
OXTPLFF	Easy Access Telescopic Platform Ladder Front Feet (pair)
OXTPLFB	Easy Access Telescopic Platform Ladder Back Feet (pair)
OXPLFT	Easy Access Telescopic Ladder Feet (set of 2)
OXPLW	Easy Access Platform Ladder Wheel (set of 4)
OXTPLW	Easy Access Telescopic Platform Ladder Wheel
FEETCAPSWH	Warthog Feet (pair)
WHELFOOT	Ext Ladder Foot (top cap) pair
LADDERHOOKS	Warthog Ladder Hook & Bolt (ea)
WHPLWC	Warthog Platform Ladder Wheels (set of 4)



WHPLFSH



OXPLFT



OXPLFT



OXPLW / OXTPLW

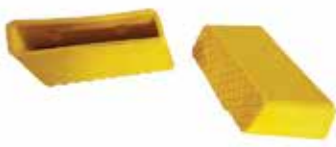

FEETCAPSWH



WHELFOOT



WHADJFFET



LADDERHOOKS



WHPLWC



Ullrich Ladder Parts

Code	Description
LADCSSDCLP	Ladder CS Side Clips
UA002.07	Ladder Hooks
LAD10295.0	UA1029 Ladder HDS Step
LADSPARE09	Ladder Pulley
LADFEETNO14	D/S & S/E Front Feet (pair left/front)
LADFEETNO4	D/S & S/E Rear Feet (pair)
LADFEETNO17	Ext Ladder Feet (pair)
LADFEETNO16	Ladder Feet for HDS Front (pair left & right)
LADFEETNO15	Ladder Feet for GRCS Front (pair left & right)
LADDST2&2A	Ladder DST No. 2&3 Side Arm Complete (pair)
LADDST4&5A	Ladder DST No. 4&5 Side Arm Complete (pair)
LADSPARE22	Ladder DST Side Arm

Code	Description
LADBRACESM	Ladder Brace Small
LADBRACEME	Ladder Brace Medium
LADBRACELRC	Ladder Brace Large
LADCSARMSM	Ladder CS 04, 05 Side Arm (pair)
LADCSARMME	Ladder CS 06, 07, 08 Side Arm (pair)
LADCSARMLR	Ladder CS 09, 10 Side Arm (pair)



Totalsite Ladder Parts

Code	Description
LSH	LadderSafe Holder (also available in 10 pack)
LSI	Orange LadderSafe Insert (also available in 10 pack)
L120	Ladder Numbers 1 - 20 Industrial High-Stik
L150	Ladder Numbers 1 - 50 Industrial High-Stik

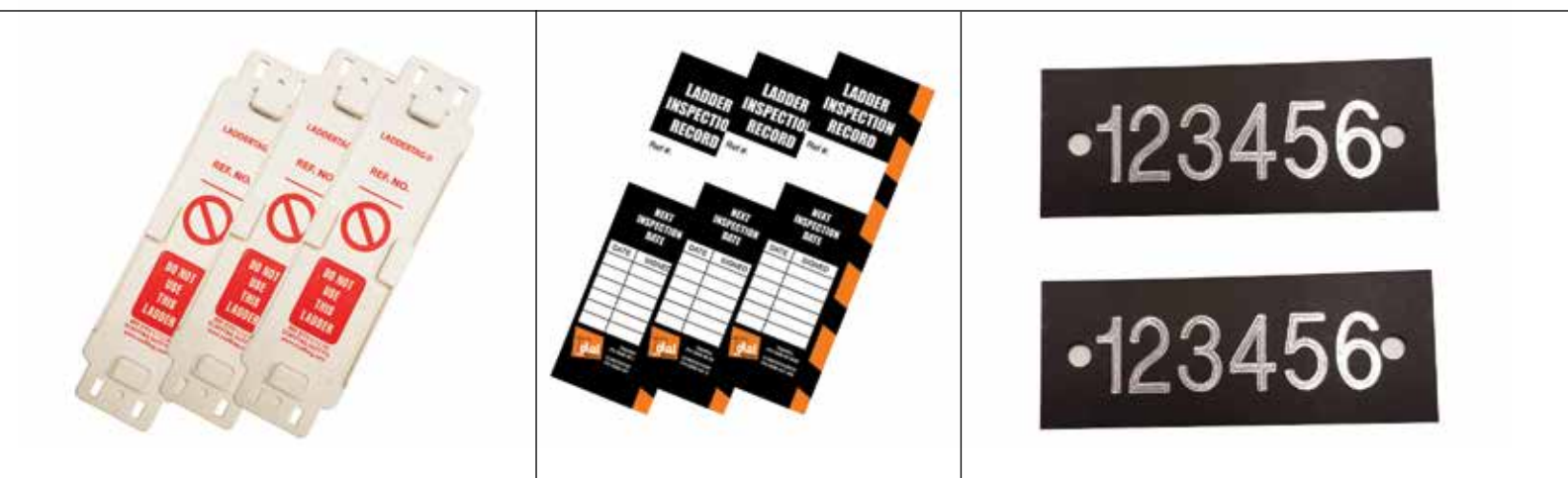



Ladder Inspection Service

Our ladder inspection service provides you a written report on the condition of your ladders including whether repairs are required and whether or not they can be done inhouse by yourselves.

Ladders that pass are given a test'n'tag label as shown below stating item number and next test date.

We use a modern software which allows our customers to manage and track their ladders (and other equipment) and view inspection history against this equipment. The software gives you access to detailed reports and can be accessed anywhere at anytime.



ITEM #: _____	NEXT INSPECT DATE: _____ MTH YEAR	INSPECTED BY: _____
-------------------------	--	-------------------------------

This item should not be used if Next Inspection Date is overdue. This label must be recorded on a register so that if manufacturer labels are unreadable, Item # can be used to validate brand, type, standard and rating.

On Site • Up High • Safely
0508 88 5656



SCAFFOLDING

Equiptec Doorway Mobile Scaffold

Nifty little scaffold that doesn't need to be dismantled to fit through a doorway.

SCAFFOLDING



1.0mH x 2.0mL x 0.7mW
(no kickboards)
Code BCD1



2.0mH x 2.0mL x 0.7mW
(no kickboards)
Code BCD2



1.0mH x 2.0mL x 0.7mW
(with kickboards)
Code DOORWAY1



2.0mH x 2.0mL x 0.7mW
(with kickboards)
Code DOORWAY2

Equiptec Single Mobile Scaffold

Economy

Platform Height

- 2.0m
- 3.0m
- 3.9m
- 4.8m

2.0mL

- SINGLE2-20T
- SINGLE3-20T
- SINGLE4-20T
- SINGLE5-20T

2.5mL

- SINGLE2-25T
- SINGLE3-25T
- SINGLE4-25T
- SINGLE5-25T

3.0mL

- SINGLE2-30T
- SINGLE3-30T
- SINGLE4-30T
- SINGLE5-30T

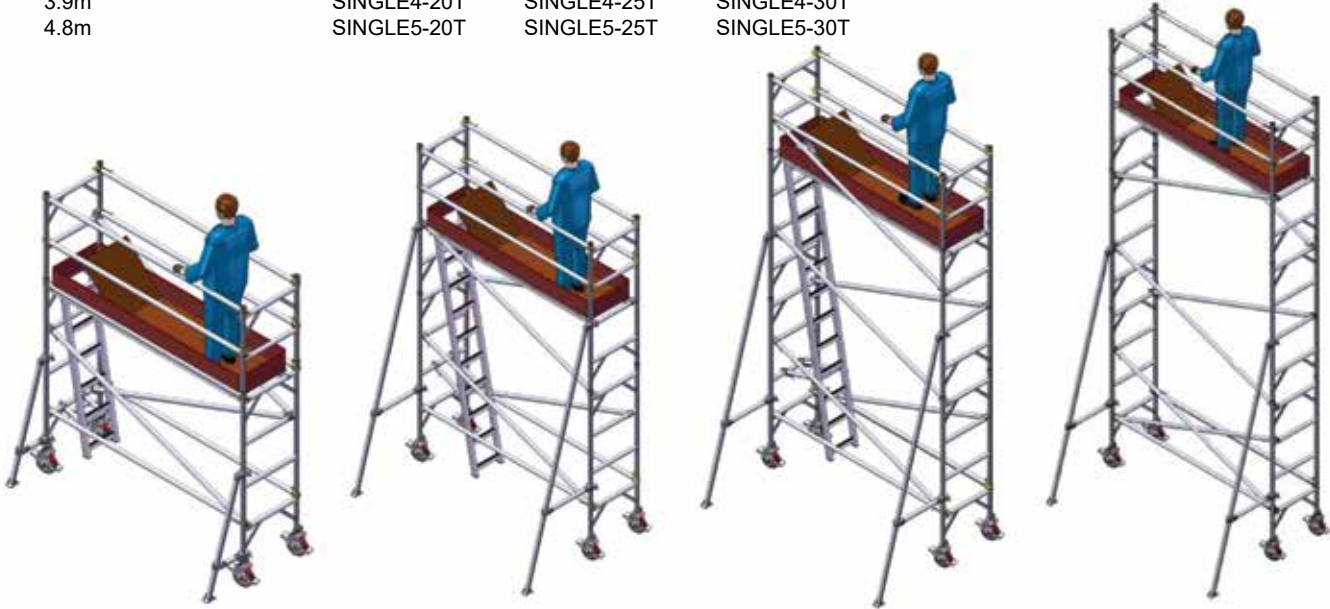

Equiptec Single Mobile Scaffold

With Extra Deck for Safe Assembly

Platform Height

- 3.0m
- 3.9m
- 4.8m

2.0mL

- SS3-20T
- SS4-20T
- SS5-20T

2.5mL

- SS3-25T
- SS4-25T
- SS5-25T

3.0mL

- SS3-30T
- SS4-30T
- SS5-30T

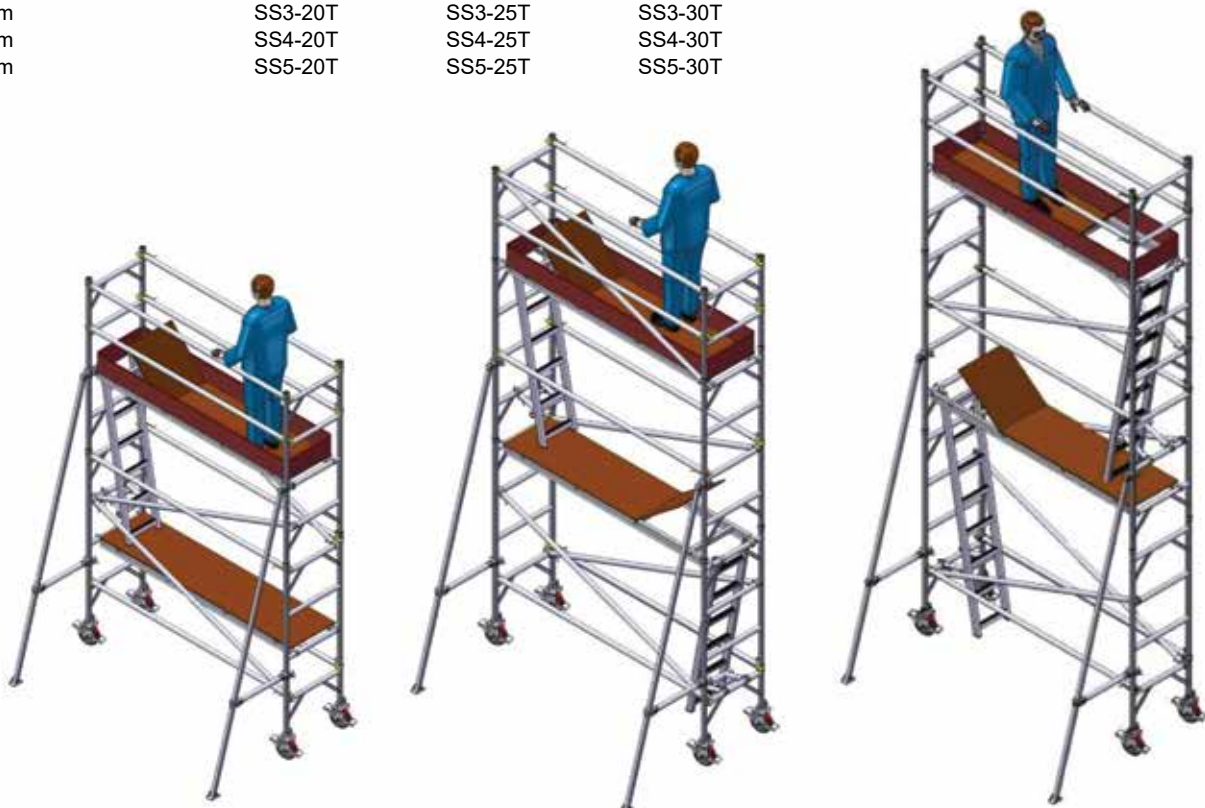

Equiptec Single Mobile Scaffold

Safe Assembly Full Spec

Platform Height

2.0m
3.0m
3.9m
4.8m

2.0mL

SSA2-20T
SSA3-20T
SSA4-20T
SSA5-20T

2.5mL

SSA2-25T
SSA3-25T
SSA4-25T
SSA5-25T

3.0mL

SSA2-30T
SSA3-30T
SSA4-30T
SSA5-30T

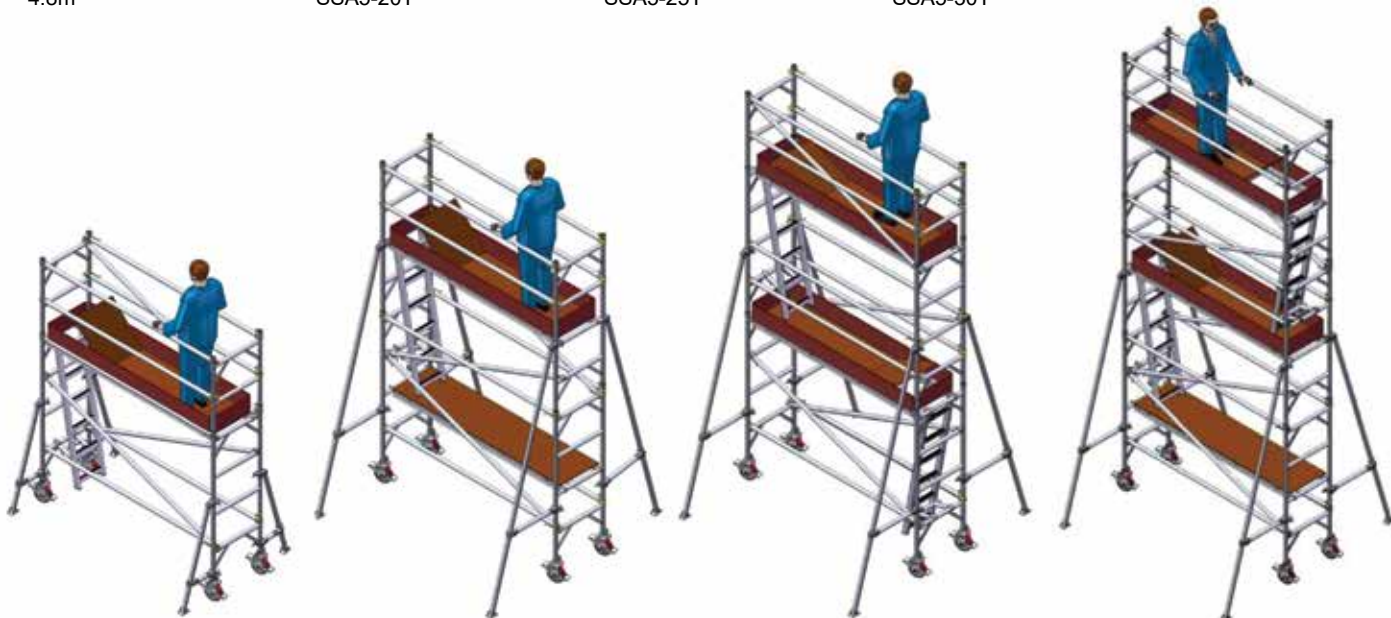

SCAFFOLDING

Equiptec Double Mobile Scaffold

Economy

Platform Height

2.0m
3.0m
3.9m
4.8m

2.0mL

DOUBLE2-20T
DOUBLE3-20T
DOUBLE4-20T
DOUBLE5-20T

2.5mL

DOUBLE2-25T
DOUBLE3-25T
DOUBLE4-25T
DOUBLE5-25T

3.0mL

DOUBLE2-30T
DOUBLE3-30T
DOUBLE4-30T
DOUBLE5-30T

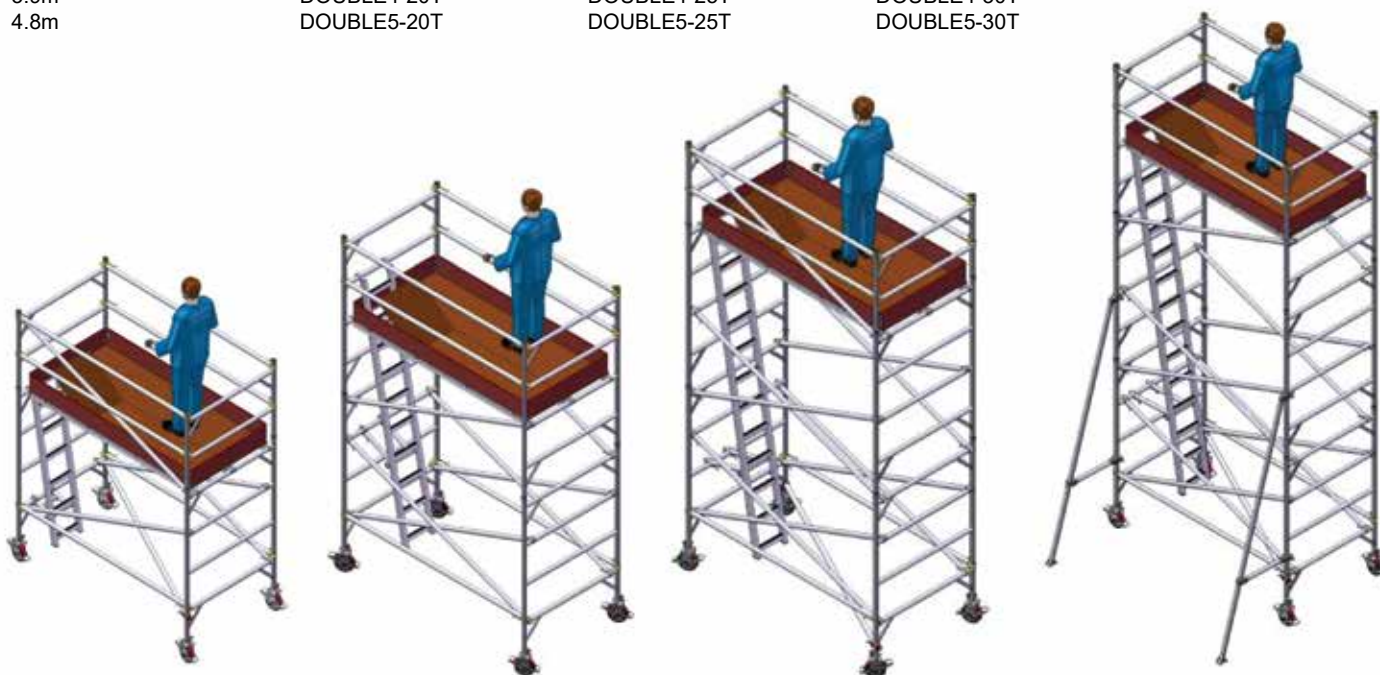

Equiptec Double Mobile Scaffold

With Extra Deck for Safe Assembly

Platform Height

3.0m	2.0mL
3.9m	DS3-20T
4.8m	DS4-20T
	DS5-20T

2.5mL

DS3-25T
DS4-25T
DS5-25T

3.0mL

DS3-30T
DS4-30T
DS5-30T



Equiptec Single Mobile Scaffold

Safe Assembly Full Spec

Platform Height

3.0m	2.0mL
3.9m	DDA3-20T
4.8m	DDA4-20T
	DDA5-20T

2.5mL

DDA3-25T
DDA4-25T
DDA5-25T

3.0mL

DDA3-30T
DDA4-30T
DDA5-30T



Equiptec Go-Gate

Many sites are insisting on handrails, midrails and toeboards on scaffolds at any height.

This makes accessing the scaffold difficult... well, it used to be before the Go-Gate was invented!



Why Equiptec Mobile Scaffold?

- Strongest** Almost impossible to break graspers and other parts
- Replaceable** In the unlikely event that a part does break, they're riveted in place, so can be easily replaced
- Sturdy** Feels a lot more rigid when it's used than other systems.
- Single System** You can purchase extra parts to increase your scaffold, and parts are interchangeable.
- Hireable** Available to hire should you require extra parts short term.
- Investment** Equiptec scaffold is a long term investment. Customers are still using it after 20 years.



Very sturdy platforms due to fully welded sub frame box section



Optional 'wind-keeper latch' prevents any chance of the wind lifting a platform



Virtually indestructible 'big-nosed' graspers



Sturdy kickboards prevents tools etc. from falling



Anti-jam spigots ensure frames fit together easily everytime



Large 200mm diameter casters, roll and brake easily

Easy Access Mobile Scaffold

Single Width

Platform Height

- 1.5m
- 2.0m
- 3.0m
- 4.0m

2.0mL x 0.7mW

- MOBI150S
- MOBI200S
- MOBI300S
- MOBI400S



Double Width

Platform Height

- 1.5m
- 2.0m
- 3.0m
- 4.0m

2.0mL x 1.3mW

- MOBI150
- MOBI200
- MOBI300
- MOBI400

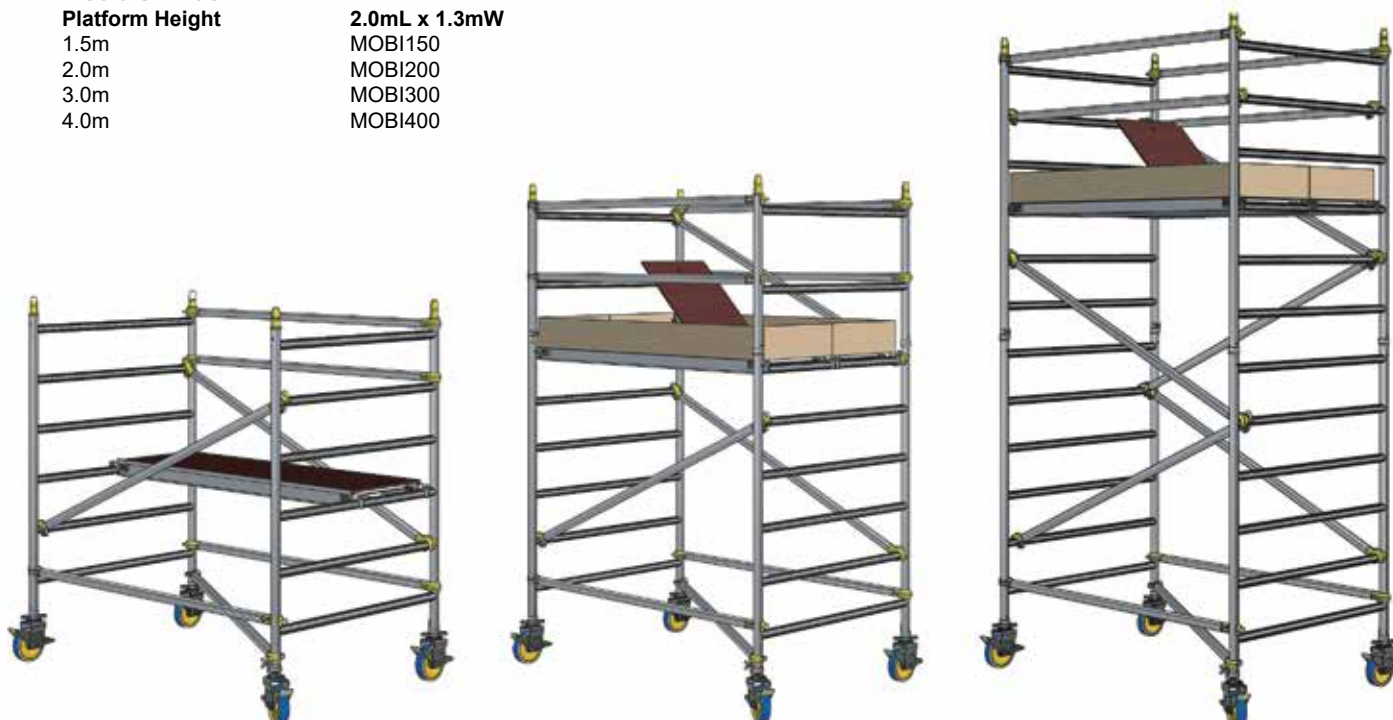

Fixed Scaffold

Scafpro Steel Scaffold is very quick to erect in many different configurations. Aluminium option also available.

Builders Pack 1
9.2m long
2.0m high platform

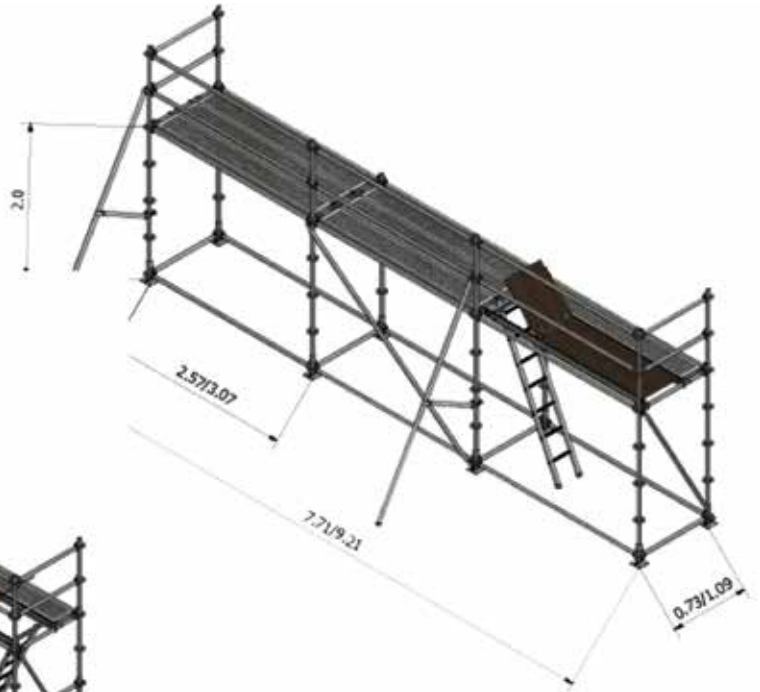
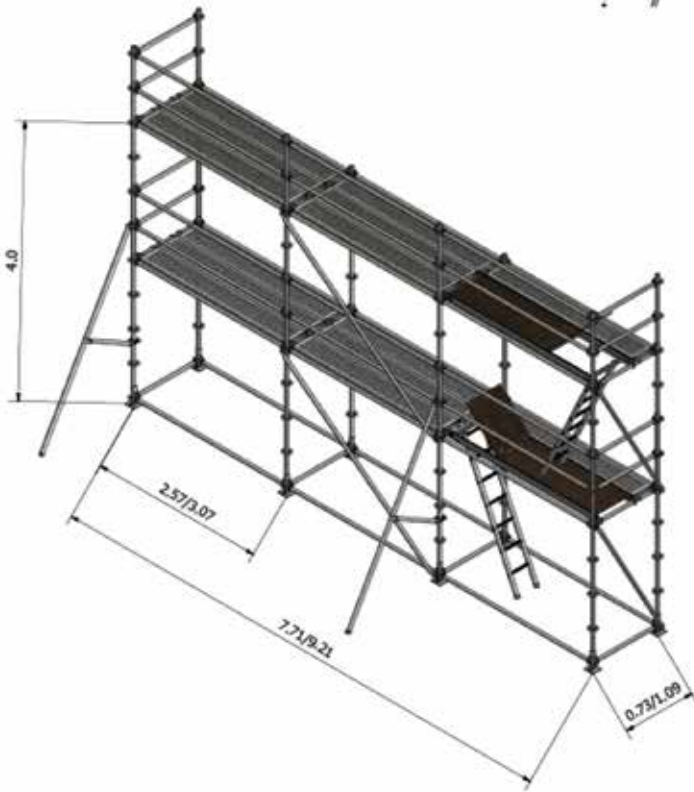

Builders Pack 2
9.2m long
2 bays high

Scaffold Safe Holder & Inserts

Scaffold Safe Yellow Holder
Code SCAFTYX

Scaffold Safe Insert
Code SCAFTS



Steel Scaffold Components



Swivel Coupler



Double Coupler



Single Coupler



Steel Full Frame



Steel Tube



Base Plate



Base Jack



Steel Half Frame



External Joiner



Internal Joiner



7/16 Spanner



Ratchet Spanner



Scaffold Belt



Level



Aluminium Planks

Code	Length
ALP2.4	2.4m
ALP3	3.0m
ALP4	4.0m
ALP5	5.0m
ALP6	6.0m



Certified Scaffold Timber Planks

Code	Length
LSP30	3.0m



**Hire options
also available!
No job too big
or too small!**

EDGE PROTECTION

Garage & Sheds Bracket

Code EBG

- New housing
- Timber framed garages
- Pole framed sheds
- Steel framed sheds
- Stackable
- Timber or tube rails



New Build Soffit Mount Bracket

Code EBA

- New housing
- Stackable
- Gable ends
- Mono pitch roofs
- Timber or tube rails



Re-Roof System Bracket

Code EBR

- New housing
- Alterations
- Existing buildings
- Re Roofing
- Solar installation
- Roof painting/coating
- All roof types
- Stackable
- Timber or tube rails



Commercial Bracket

Code EBC

- DHS purlins
- Timber purlins
- Timber and concrete floor perimeters
- Parapet walls
- Stackable
- Timber or tube rails
- Extendable/adjustable with multi bracket



Standard Edge Protection

These aluminum Edge Protection Packs are quick to install and can accommodate to different height requirements. The packs are designed to be used without fixing to the building or using any patching, making it the ideal solution for roofers, plumbers and restorers.

Code PACKE

52m Full House Edge Protection

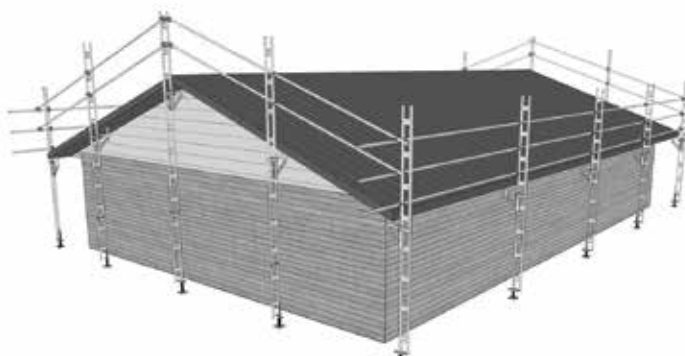

Code PACKA

12m Edge Protection including 1/2 Gable End

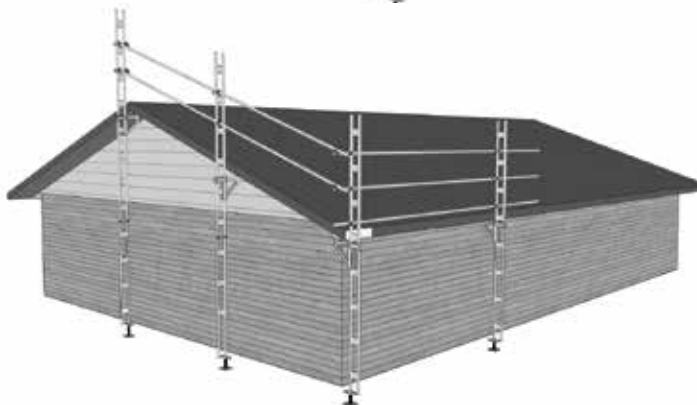

Code PACKC

6m Straight Edge Protection

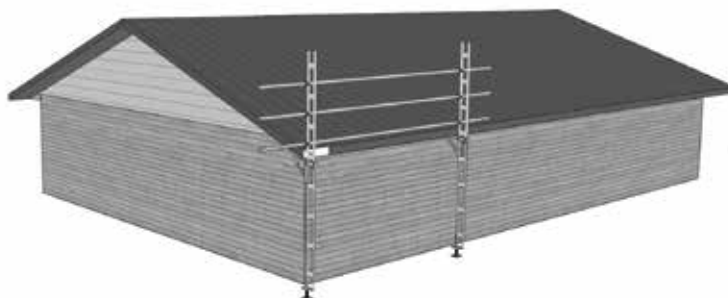

Quik-Guard Edge Protection

Code EASYRAIL

Quik Guard keeps staff safe, is fully compliant, effective and efficient. Quik Guard roof edge protection is installed fast, provides a strong safe protective barrier and can be dismantled quickly when the job is complete.

Quik Guard has no need to penetrate the building structure, building roofs and walls are left untouched.

Quik Guard does not require rakers (when used at 5.0m or below)! This system can be installed fast, even on difficult sites.

Tested and certified compliant with safety standard AS/NZS4994.1.

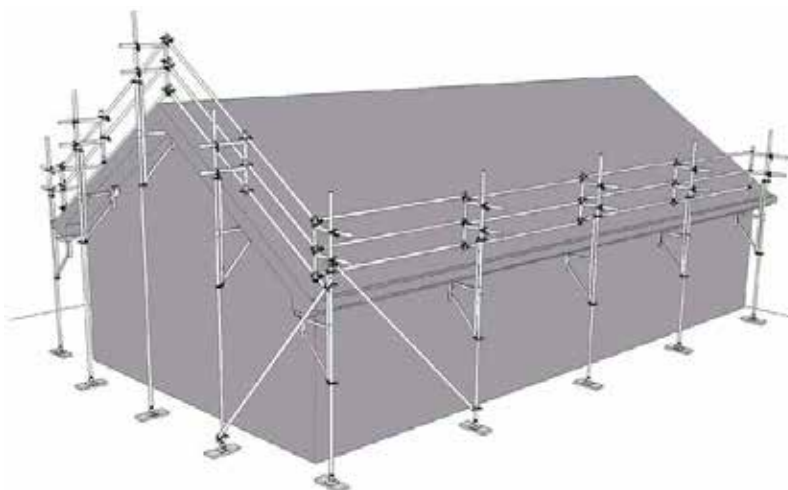

Platform Edge Protection

The free-standing Platform EdgePro system is very lightweight and reduces the downtime of waiting for your scaffold company to arrive. EdgePro and can simply be erected on uneven ground and with a little training, you can do it yourself.

Code PACKK

0.5m – 3m high platform. 70L/m including internal and external corners.

PACK SIZES
CUSTOM
DESIGNED
TO SUIT YOUR
NEEDS

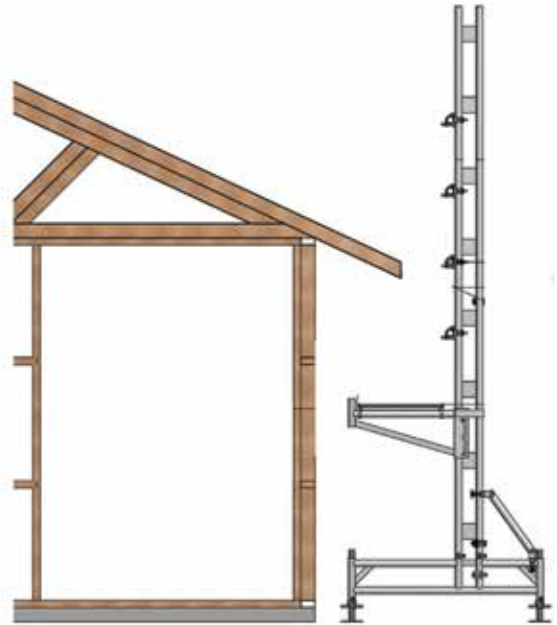
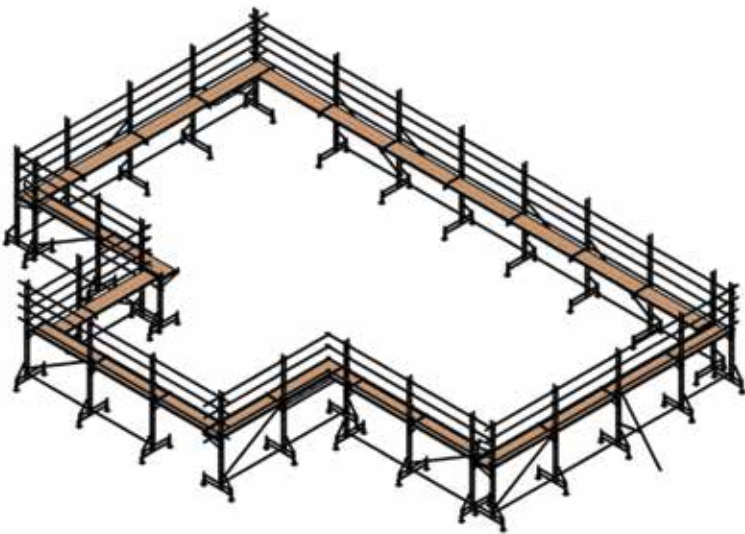

Code PACKJ

0.5 – 3m high platform. 21m straight

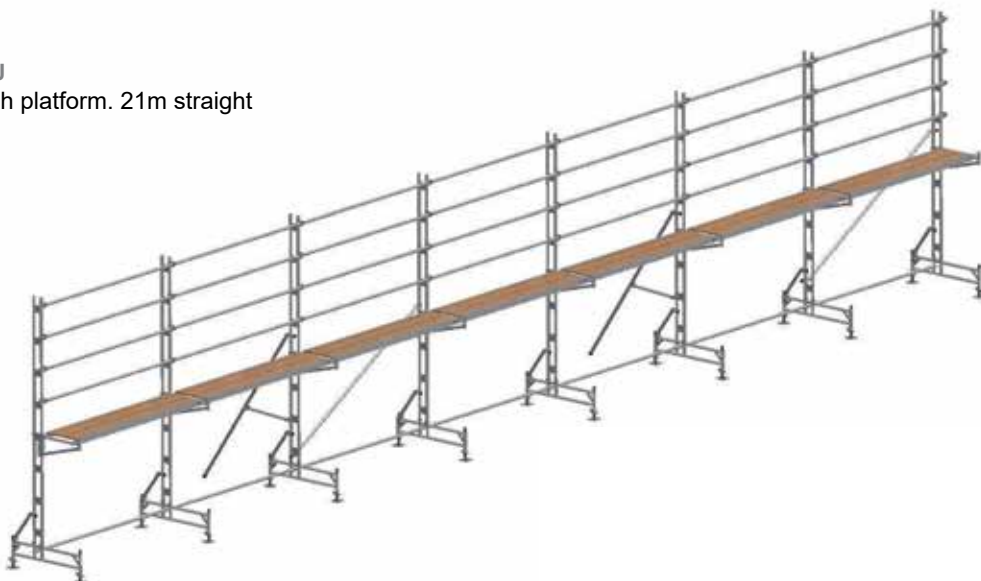

King Klamps

Code: KKM1000

King Klamps can be fitted both vertically and horizontally to provide a secure edge protection system on concrete, parapets, mezzanine floors and many other applications.



Parapet & Slab Clamp

Code: EPB

- Parapet walls
- Concrete slab edges
- Floor mounting with toeboard
- Commercial buildings
- Timber or tube rails
- Stairwells and voids
- Lightweight tube rails





HEIGHT SAFETY

Harnesses

Zero Utility Fall Arrest Harness

Code HUS0017 (Z-30)

Simple and effective fall arrest harness for total safety compliance. Certified to AS/NZS 1891.1:2007.



Zero Superior Multi-Purpose Harness with Positioning Belt

Code HSP0167 (Z+52)

Ideal for the professional construction worker that demands comfort and premium safety. Breathable mesh fabric in the shoulder and leg pads gives the wearer support and comfort while helping to keep them cool and dry. Certified to AS/NZS 1891.1:2007.



Zero UtilityS Fall Arrest Harness

Code HUSB017 (Z-30S)

Suitable for general tradesmen, construction workers, roofing, vertical climbing and access equipment. Basic buckles for economy. Simple and effective fall arrest harness for total safety compliance. Certified to AS/NZS 1891.1:2007.



Zero Elite Construction Harnessfall Arrest & Suspension Harness

Code HEP4678 (Z-61)

Rescue attachment points on the shoulders, ideal for confined space raising and lowering. Versatile design allows use for a multitude of work applications. Certified to AS/NZS 1891.1:2007.



Zero IsoElec Isolated Electrical Linesman Harness

Code HIP4678 (Z+81/EISOL)

The IsoElec harness provides all the comfort and benefits of Elite Construction Harness but includes specially isolated metal parts to protect electrical linesman and tower workers from electrical arc. The IsoElec Harness is also suitable for general purpose, light abseil, work positioning and fall arrest. Certified to AS/NZS 1891.1:2007.



Zero Plus Riggers Harness

Code HPP1679 (Z+87R)

Comfortable and efficient construction harness; Suitable for general purpose construction work, roofing, confined space, vertical climbing and access equipment.



Zero Works Abseil / Rescue Harness

Code HWP4689 (Z+71)

A favourite with emergency services and rope access technicians, the Works Rescues Harness provides additional flexibility with its V construction. Versatile design allows use for a multitude of applications including general rope access, abseil, rescue, industrial fall arrest, work positioning, tower and confined space.



Premium Y-Tech Pro Tower Harness

Code YTECH-PRO

The Y-Tech Pro Tower Harness has been developed following extensive consultation with our power utility end-users, giving them the features they desire most. This harness has been designed to eliminate restriction on the shoulders, allowing total upper body movement.



Height Safety Kits



Zero Basic Roofers Kit

Code RKB-200
Basic Z-30S Harness and 15m Ropeline

Zero Roofers Kit

Code SKB101 (ZB-101)
Suits general roof work. Quick Connect Harness, 15m Ropeline, Anchor, Sling & Backpack.



Zero Tradesman Kit

Code SKB501 (ZB+501)
The complete kit for tradesmen working at height. Z+32 Harness with double lanyard, 15m Ropeline, & Apex Multi Helmet.

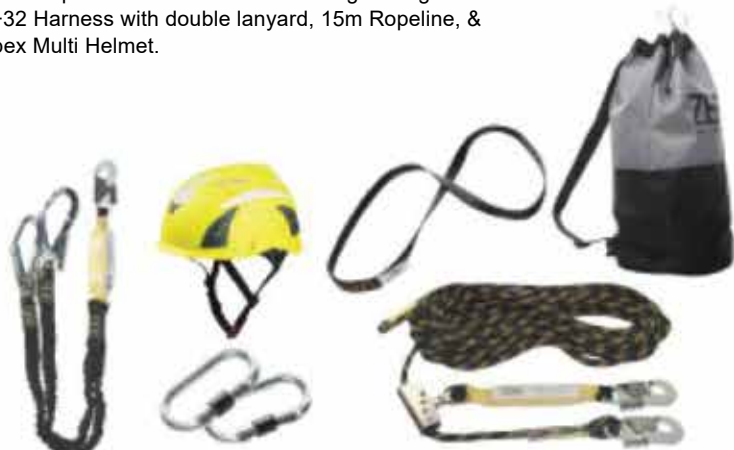

Helmets



Apex Flash Helmet

Code APX-02

Quality construction ensures the Exo industrial helmet is built to last and has provision for all the standard accessory types that are needed on the job. Impact and penetration protection meets and exceeds AS/NZS 1801.



Apex Multi Helmet

Code APX-05

Designed to mountaineering impact certification, for industrial use, with a collation of the best design features for an industrial quality helmet for work at height and general site safety.

Will your helmet protect you from multiple side hits if you fell?

“When fall arrest systems are used, an appropriate helmet shall be worn to protect the worker from head injury during an uncontrolled fall”

- Quote Best Practice guidelines for working at height in NZ.



Petzl Vertex Vent Helmet

Code A10V

A very comfortable and stylish height safety helmet with six point mesh liner which conforms to the shape of the head for improved comfort. Ventilation holes with sliding shutters. Optional head lamp, visor and earmuffs. EN12492.



Pinnacle Vent Helmet

Code ZPE-01

European manufactured and certified to meet even the most stringent demands of the industrial market, the ZERO® Pinnacle EXO series are bolstered by the standard for mountaineers (EN 12492:2012) for superior protection whether on the ground or working at height.



Pinnacle Volt Helmet

Code ZPE-02

European manufactured and certified to meet even the most stringent demands of the industrial market, the ZERO® Pinnacle VIKO series meet the standard for industrial protection (EN 397).

Helmet Accessories



Zero Pinnacle Visor - Full Face

Code ZPVF01

A medium impact rated ultra-clear full-face visor designed to fit directly to all Pinnacle Volt helmets. With no metal parts, the Low Elec visor provides protection against short circuit electric arc.



Zero Pinnacle Visor - Half Face

Code ZPV01

The impact-resistant ZERO Clear visor fits directly to the full range of Pinnacle helmets and protects from flying particles.



Pro Choice Safety Gear Python® Slimline Hard Hat Earmuffs

Code HHEMPYTS

Class 5, SLC80, 31dB. Hearing protection for noise levels to 116dB(A). Fits a wide range of hard hats



LED Sensor Head Lamp

Code HL120

Can be fitted to most helmets. 100 Lumen LED.

Lanyards



Zero 2m Single Webbing Lanyard with Snaphooks

Code LWZ00W3 (ABM-T3)

Webbing lanyard with snaphooks at both ends. Includes shock absorber. 2m length.



2m Single Adjustable Rope Lanyard with Scaffold and Snaphook

Code LLZ0RX5 (ABM-RL5)

Single Adjustable rope lanyard with snaphook and scaffoldhook. Includes shock absorber. Adjustable length from 1.2m to 2m.



Zero Double Elasticated Lanyard with Snaphook & Scaffold Hook

Code LSZ2W5E (ABM-2T5E)

Elasticated webbing lanyard with 2 scaffoldhooks. ideal for scaffolders as lanyard straps don't dangle around the legs.



Zero Adjustable Lanyard

Code LTZ0WX3 (ABM-TX3) / Code LTZ0WX5 (ABM-TX5)

2m Adjustable webbing lanyard with snaphooks. Suitable for EWP use where the lanyard must be shortened. ABM-TX5 comes with Scaffold hooks

Zero Logix Retractable Webbing Lanyard

Code LLRZ0W3 (AH-210)
 Fall arrester with webbing retractor.
 Max length 2.25m EN360,
 AS/NZS1891.3



2m Webbing Double Retractable Lanyard

Code CR-02X2
 Ideal for scaffolders who are required to be attached at all times.



Adjustable Rope Pole Strap with Aluminium Rope Grab and Swivel Hook

Code SBL12AS
 The combination of AS/NZS approved Kernmantle rope and rope grab allows the user to quickly adjust the length of the strap on the fly.



Adjustable Pole Strap

Code WPR0WX3 (ZF-725)
 AS/NZS1891.2. 2.5m ideal for lineworkers



Work Positioning Lanyard with Rope Grab 3m

Code WPG0RX3/030 (AF-130/030)
 Work positioning device with rope grip shortener for perfect length



Zero Linostop 15mm Ropeline with Adjuster

Codes:
 RV20RX3/150 (ZRL-15)
 RV20RX3/200 (ZRL-20)
 RV20RX3/300 (ZRL-30)
 15m rope line with a rope adjuster and shock absorber. Other lengths available - 20m & 30m. Certified to AS/NZS 1891.3:1997.



Zero 11mm Tactix Kernmantle Static Rope, 30m

Code ZTE11/30 (ZT-11/30)
 Tactix kernmantle static rope complete with sewn loop ends with reinforced eyelets and one snaphook. 11mm rope, 30m Long.

Anchors



Zero Roof Anchor To Go

Code AAP000M (AZ-200)
 Quick anchor for iron roofs



Zero Tether Plate 500mm

Code ATD000M (AZ-160)
 Diversionsary anchor (must be used in conjunction with a primary anchor) to provide a safe secure anchorage point for metal roofing tasks, both fall arrest and restraint.



Templink Flexible Anchor

Code TPKL

Flexible anchor can fit to almost any iron roof and many other situations.



Froglink Anchor

Code FROGLINK

Permanent energy absorbing anchor for fitting to metal roof sheeting. Quick and effective permanent anchor with fall impact absorption.



Temporary Lifeline

Adjustable static line for 1-3 people. Ideal for roof work.

Code

AZP0WX3/200
109501

20m 3 Person (Zero)
30m 2 Person (Camp)



Zero Alu Beam Anchor

Code AAB00XM (AT-250)

EN795, CLASSB. Designed as temporary, portable anchor point. It is to be fixed onto horizontal steel beam which must be mounted permanently to the stable structure. Quick connect mechanism fitted in seconds



Webbing Sling

Webbing sling available in six different lengths. 22kN

Code

ASP000W/006 (ZS-60)
ASP000W/008 (ZS-80)
ASP000W/012 (ZS-120)
ASP000W/015 (ZS-150)
ASP000W/020 (ZS-200)

Length

60cm
80cm
120cm
150cm
200cm



Quicklink Oval Karabiner

Code PJ-507

Excellent for semi-permanent fixings. Screw lock. 72mm x 17mm with 17mm opening. Steel/zinc plated



Zero Triple Lock D Karabiner

Code PJ-500

Triple Lock, D Shape Karabiner. High tensile steel, yellow chromate finish.



Zero Screw Gate Oval Karabiner

Code PJ-501

Screw gate oval karabiner. High tensile steel, zinc plated. 165gms



Zero Rope Fall Arrester with Karabiner

Code FFORM1 (AC-040)

Guided type fall arrester for flexible anchorage line. Can be attached at any point along the 11-12mm rope.



Zero Kevlar Webbing Retractable Lanyard

Code FKR00W3 (WR-100/06)

Retractable fall arrester allows for extra movement. EN360:2002



Trauma Straps - pair

Code ZC-2062

Helps prevent the effects of suspension trauma by prolonging the allowable suspension time for a person who has experienced a fall.

Confined Space



Zero Aluminium Tripod 229cm with Chain

Code TD00AX (TM-9)

This industrial multi-functional Tripod is ideal for lifting loads, assisting in access to confined spaces, as well as for securing and rescuing people. 500kg rated.



Zero Winch with Pulley & Mounted Bracket 20m

Code WD00CM/200 (RUP-502-20)

Lifting rescue device. Lifting and lowering device with automatic breaking. Ideal for confined space work and rescue.



Spreader Bar with Karabiners

Code CS00W1 (ZSB)

Spreader Bar suitable for use with RUP-502 winch & Z-40 harness for all confined space access.



Zero Retractable Rescue Winch/Inertia Reel - 25m

Code FBR2RC3/250
(CRW-300/25)
A combination of a self locking device and rescue lifting device; a type 3 fall arrester. Suitable for use on TM9 Tripod. EN360, EN1496, Class B



Skylotec Milan 2.0 Hub

Code A-028
Rescue system to recover a suspended person from almost any situation - both ascending and descending. Includes bag and karabiners.

Rescue Kit 50m

Code AR-010
Zero Rescue Descent Kit is an evacuation and rescue unit designed to rescue/recover a person at height. Descending only. It can be used during rescue operations at height for works who are suspended in PPE.



Controlled Rate Descender

Code RED000R (YIE-003)
For self evacuation from bucket trucks and pole top rescue. Excludes rope



A range of Kit Bags available
Various Styles & Sizes.

Tool Tethering



Code TKLETA
Elasticated tool lanyard with tool attachment. Rated to 2kg



Code TKLETAQR
Tool lanyard green with quick release buckle. Rated to 5kg



Code TKLTA
Tool lanyard with tool attachment. Rated to 5kg



Code AY-002
Elasticated hand tool lanyard. Rated to 5kg



Code TKLETA
Elasticated tool lanyard with tool attachment. Rated to 5kg



Code TKLDR
Tool Lanyard with D-ring. Rated to 5kg



Code TLESS
Yellow stainless steel elasticated lanyard with swivel and snap hooks



Code TKBLDBLV
Double belt loop with velcro. Rated to 5kg



Code TKWSE
Elasticated wrist strap. Rated to 5kg



Code TKBLDBL
Fixed double belt loop with double D-ring. Rated to 5kg



Code TKBLSINGR
Quick release belt clip with single D-ring. Rated to 5kg



Code TKBLSINV
Velcro release belt loop with single D-ring. Rated to 5kg



Code SBLTLW
Wrist strap choke with tool lanyard All in One. Rated to 5kg



Code TKWSQR
Wrist strap with quick release buckle. Rated to 5kg



Code TKWSV
Wrist strap with Velcro.. Rated to 5kg



ELEVATED WORK PLATFORMS

ELEVATED WORK PLATFORM



Man Cage

Code FMC 19-120

The 2 person man cage is designed for forklift use to safely carry out tasks of short duration and occasional usage such as maintenance work or stock-take.

- Safe working load 250kg
- Unit weight 110kg
- Galvanised zinc coated



Slipper Locking Pins



Anchor Points



Handy Tool Tray

4m - 5m Slab Scissor Lifts

The Snorkel S3010P is an innovative push-around mini scissor lift, which provide a cost-effective way to safely work at low level heights indoors.

Designed to withstand the demands of construction sites and the rental industry, the Snorkel S3010P is a heavy-duty and robust mini scissor lift, which is easy to use and simple to maintain. The S3010P can lift 240kg to a working height of 5.0m.

Features

- Auto brake system
- Tilt sensor
- Saloon-door style entry gates
- Integrated battery charger 90V – 240V
- Battery charge indicator
- Forklift pockets
- Emergency lowering system
- Non-marking casters
- Slide-out service trays
- 2 year parts & labour, 5 year structural warranty

Code	S3006P	S3008P	S3010P
Max. working height	4.0m	4.5m	5.0m
Max. platform height	2.0m	2.5m	3.0m
Platform size (outside)	1.1m x 0.52m	1.1m x 0.52m	1.1m x 0.52m
Overall width	0.75m	0.75m	0.75m
Overall length	1.2m	1.2m	1.2m
Stowed height	1.7m	1.8m	1.8m



Quick Up 12 Lift

Features

- Adapted to each project
- Its lightweight makes it suitable for the most fragile grounds
- Its compactness enables to go through doors and elevators
- Its stabilizers with rubber protect the floor surface
- Easy to use
- Quick set up by 1 person
- Transportable on a trailer or a van
- 4 wheels for easy manual maneuvering
- Best value for money
- Minimal maintenance

Code QUICKUP12

Working height	12.3 m
Platform height	10.3 m
Platform size	0.68 x 0.66 m
Length	1.4 m
Width	0.8 m
Width - stabilised	2.06 m
Length - stabilised	2.26 m
Weight	415 kg



EcoLift

Ideal for finish work, multi-story projects. Used by mechanical, electrical and HVAC contractors, painters, etc.

Features

- Facility Maintenance: Cleaning, painting, decorating and general building maintenance in offices, schools, hospitals, institutional and industrial maintenance
- Intuitive to operate – turn handle to elevate Patented* lift mechanism, no power required

Code	Ecolift 50	Ecolift 70
Working height	3.33m	4.03m
Platform height	1.5m	2.2m
Machine Weight	180.08kg	304.81kg
Platform Length	0.71m	0.85m
Platform Width	0.6m	0.65m





6m - 10m Slab Scissor Lifts

The Canadian built Skyjack machine is designed for the hire industry so is very robust. Maintenance and servicing work is seldom required, and is very simple to do.

Features:

- Crossover symmetrical 4WD
- Independent/auto leveling outriggers
- 0.9m roll out platform
- Electric engine
- 90° swing out engine tray
- Tilt alarm with drive & lift cut-out
- Overload sensing system
- Pothole protection system
- Solid rubber, non marking tyres

Code	SJIII3215	SJIII3219	SJIII3220	SJIII3226	SJIII4626	SJIII4632
Working height	6.57m	7.79m	8.10m	9.92m	9.92m	11.75m
Platform height	4.57m	5.79m	6.10m	7.92m	7.92m	9.754m
Machine Weight	1120kg	1579kg	1889kg	1890kg	2935kg	2935kg
Platform Length	1.63m	1.63m	2.13m	2.13m	2.13m	2.13m
Platform Width	0.66m	0.66m	0.71m	0.71m	1.07m	1.07m



8m - 10m Rough Terrain Scissor Lifts

Exclusive cross over symmetrical 4WD system for superior traction. Featuring up to 50% gradeability, these machines can meet the needs of the most challenging job site terrain. Standard features also include an easy to use 1.52m roll out extension deck, which can be secured in multiple positions for increased platform space and improved reach capabilities. Driveable at full height with the roll out deck fully extended.

Features:

- Crossover symmetrical 4WD
- Independent/auto leveling outriggers
- 1.52m roll out platform
- Diesel/electric engine
- 90° swing out engine tray
- Tilt alarm with drive & lift cut-out
- Overload sensing system
- Pothole protection system
- Solid rubber, non marking tyres

Code	6832RTE	6826RT	6832RT
Working height	11.75m	9.92m	11.75m
Platform height	9.8m	7.9m	9.8m
Machine Weight	4026kg	3305kg	3655kg
Platform Length	2.44m	2.44m	2.44m
Platform Width	1.42m	1.42m	1.42m
Electric or Diesel	Electric	Diesel	Diesel